

# PROGRAM



**72nd ANNUAL MEETING**

**Southern Region**

of the

**American Society for Horticultural Science**

**February 3-6, 2012**

**Birmingham, AL**

## **Southern Region ASHS**

The Southern Region ASHS is a regional scientific society of the American Society for Horticultural Science. The Southern Region encompasses the 14 southern states of Texas, Louisiana, Oklahoma, Arkansas, Mississippi, Georgia, Alabama, Florida, South Carolina, North Carolina, Virginia, West Virginia, Kentucky and Tennessee. Membership varies over the years from about 300 to 500 active members. Membership is composed of research scientists, teachers and extension specialists from Universities, State, Federal and private research organizations, and industry. The Southern Region also contains a student section, the Association of Collegiate Branches, which is composed of student clubs from departments of horticulture and plant science across the region. The main focus of the Southern Region is the Annual Meeting, which is held every February in conjunction with the Southern Association of Agricultural Scientists (SAAS). The Annual Meeting consist of presentations of scientific papers, student paper competitions and judging contest, commodity group meetings, and awards presentations.

### **Goals:**

- **Encourage and facilitate the mutual exchange of ideas and information concerning horticultural research, extension, education, and industry in the south**
- **Promote stronger bonds among horticulturists in the southern regions**
- **Encourage participation in the international society of the American Society for Horticultural Science**

**The Southern Region ASHS is recognized widely as the strongest and most active Region of the American Society for Horticultural Science, and has a history that goes back to 1920! Join us and become a part of the Tradition.**

### **President**

**Brian Kahn**

Dept. Horticulture and  
Landscape Architecture  
Oklahoma State University  
360 Ag Hall  
Stillwater, OK 74078-6027

Phone: 405-744-7585  
Fax: 405-744-9709  
brian.kahn@okstate.edu

### **President-Elect**

**David Creech**

Department of Agriculture  
P.O. Box 13000  
Stephen F. Austin State Univ.  
Nacogdoches, TX  
75962-3000

Phone: 936-468-4343  
Fax: 936-468-4747  
dcreech@sfasu.edu

### **Secretary-Treasurer**

**David Wm. Reed**

Dept. of Horticultural Sciences  
Texas A&M University  
College Station, TX  
77843-2133

Phone: 979- 458-0701  
Fax: 979-845-6083  
dwreed@tamu.edu

### **Web Site**

**[srashs.org](http://srashs.org)**

**Visit It**

**PROGRAM**  
**72nd ANNUAL MEETING**  
**Southern Region**  
**American Society for Horticultural Science**  
**Birmingham, AL**  
**February 3-6, 2012**

**SPECIAL EVENTS AND SESSIONS**

**FRIDAY, February 3, 2012**

**8:00 am - 5:00 pm      Sweet Potato SCRI**  
 Presiding:      Tara Smith  
 Room:              MFCC Medical Forum A

**SATURDAY, February 4, 2012**

**7:00 am - 6:00 pm      Registration**  
 Presiding:      David Reed and Staff  
 Room:              Sheraton Hotel Lobby

**8:00 am - 12:00 pm      Certified Horticulturist Examination**  
 Presiding:      Mike Neff  
 Room:              SBH Jefferson Boardroom 2

**8:00 am - 5:00 pm      National Sweet Potato Collaborators**  
 Presiding:      Ramon Arancibia  
 Room:              MFCC Medical Forum A

**8:00 am - 5:00 pm      Pecan Research and Extension Forum**  
 Presiding:      Monty Nesbitt  
 Room:              SBH Birmingham Ballroom V/IX

**8:00 am - 5:00 pm      Southern Blueberry/Small Fruit Workers**  
 Presiding:      Elina Coneva  
 Room:              SBH Birmingham Ballroom III

**10:00 am - 11:30 am      ACB Program, Share Club Activities and Refreshments**  
 Presiding:      Derrick Farlee, ACB President  
 Room:              SBH Birmingham Ballroom IV

**12:00 noon 5:00 pm      ACB Group Lunch and/or Tour**  
 Presiding:      Derrick Farlee, ACB President  
 Room:              SBH Birmingham Ballroom IV

**1:00 pm - 5:00 pm      Horticulture Administrators**  
 Presiding:      Doug Bailey  
 Room:              SBH Jefferson Boardroom 2

**6:00 pm - until          ACB Reception and Mixer**  
 Presiding:      Derrick Farlee, ACB President  
 Room:              SBH Birmingham Ballroom IV

**5:00 pm - 6:00 pm Executive Committee Meeting**  
 Presiding: Dale Maronek, Chair, Executive Committee  
 Room: SBH Jefferson Boardroom 2

## **SUNDAY, FEBRUARY 5, 2012**

**7:00 am - 4:00 pm Registration**  
 Presiding: David Reed and Staff  
 Room: SBH Birmingham Ballroom Vestibule

**8:00 am - 12:00 pm Set up Posters**  
 Presiding: Thayne Montague  
 Room: SBH Birmingham Prefunction

**8:00 am - 12:00 noon J. Benton Storey Horticulture Judging Contest Setup**  
 Presiding: Jeff Atkins, ACB Advisor  
 Daniel Messick, ACB Vice President  
 Room: MFCC Medical Forum J/K

**8:00 am - 11:00 am Extension Section**  
 Presiding: Lenny Wells  
 Room: MFCC Medical Forum D

**8:00 am - 5:00 pm National Sweet Potato Collaborators**  
 Presiding: Ramon Arancibia  
 Room: MFCC Medical Forum A

**8:00 am - 4:00 pm Watermelon Research Group**  
 Presiding: Jonathan Schultheis  
 Room: SBH Birmingham Ballroom XI

**8:00 am - 9:30 am J. B. Edmond Undergraduate Student Paper Competition**  
 Presiding: Derrick Farlee, ACB President  
 Brian Kahn, SRASHS President  
 Bill Evans, Section Chair & Judging Coordinator  
 Room: SBH Birmingham Ballroom V/IX

**9:00 am - 12:00 noon Vigna Crop Germplasm Committee**  
 Presiding: Jeff Ehlers  
 Room: SBH Birmingham Ballroom III

**9:30 am - 2:30 pm Norman F. Childers M.S. Student Paper Competition**  
 Presiding: David Creech, President Elect  
 Room: SBH Birmingham Ballroom V/IX

**12:00 noon - 4:00 pm Poster Session Viewing**  
 Room: SBH Birmingham Prefunction

**1:00 pm - 4:00 pm National Cowpea Improvement Association**  
 Presiding: John Trachta  
 Room: SBH Birmingham Ballroom III

**12:00 pm - 4:00 pm J. Benton Storey Horticulture Judging Contest**  
 Presiding: Jeff Atkins, ACB Advisor  
 Daniel Messick, ACB Vice President  
 Room: MFCC Medical Forum J/K

**2:30 pm - 4:00 pm Warren S. Barham Ph.D. Student Paper Competition**  
 Presiding: David Creech, President Elect  
 Room: SBH Birmingham Ballroom V/IX

**3:00 pm - 4:00 pm Education Section**  
 Presiding: Carolyn Robinson  
 Room: MFCC Medical Forum C

### SAAS Program

**4:00 pm - 6:00 pm SAAS Opening Session and Business Meeting**  
 Presiding: William Richardson, President SAAS  
 Room: MFCC Auditorium Theater

## MONDAY, FEBRUARY 6, 2012

**7:00 am - 10:30 am Registration**  
 Presiding: David Reed and Staff  
 Room: SBH Birmingham Ballroom Vestibule

**8:00 am - 10:30 pm Poster Session Viewing**  
 Room: SBH Birmingham Prefunction

**8:00 am - 10:30 am Vegetable Crops Section**  
 Presiding: Juan Diaz-Perez  
 Room: BJCC East Meeting Room F

**8:00 am - 10:30 am Fruit Crops Section**  
 Presiding: Jay Spiers  
 Room: BJCC East Meeting Room I

**8:00 am - 10:30 am Floriculture, Ornamentals and Turf Section**  
 Presiding: Paul Thomas  
 Room: BJCC East Meeting Room G

**8:00 am - 10:00 am Postharvest/Biotechnology/Plant Biology Section**  
 Presiding: David Picha  
 Room: BJCC East Meeting Room H

**9:00 am - 10:30am ACB Business Meeting**  
 Presiding: Derrick Farlee, ACB President  
 Room: MFCC Medical Forum Auditorium

**10:30 am - 12:30 pm Annual Business Meeting and Award Program**  
 Presiding: Brian Kahn, President  
 Room: MFCC Medical Forum Auditorium

**1:00 pm - 3:00 pm Vegetable Crops Section**  
 Presiding: Juan Diaz Perez  
 Room: BJCC East Meeting Room F

**1:00 pm - 2:30 pm Fruit Crops Section**  
 Presiding: Jay Spiers  
 Room: BJCC East Meeting Room I

**1:00 pm - 3:30 pm Floriculture, Ornamentals and Turf Section**  
 Presiding: Paul Thomas  
 Room: BJCC East Meeting Room G

**12:30 pm - 3:30 pm Poster Session Take Down**  
 Room: SBH Birmingham Prefunction

## SECTION TITLES

**SUNDAY, FEBRUARY 5, 2012**

### **J. B. EDMOND UNDERGRADUATE STUDENT PAPER COMPETITION**

**Room:** SBH Birmingham Ballroom V/IX  
**Presiding:** Derrick Farlee, President, ACB  
Brian Kahn, President, SRASHS  
Bill Evans, Section Chair and  
Judging Coordinator

**Abstracts:** To publish abstract in *HortScience*, see instructions at end of program. Submit on disk at meeting or email to Chair: (wbe@ra.msstate.edu).

**8:00 am – 9:30 am Order of presentations determined by drawing at beginning of contest.**

**Determining Rhizome Maturity in Reblooming Iris.** Joshua K. Craver\* and Richard L. Harkess. Dept. of Plant and Soil Sciences, Mississippi State University, 117 Dorman Hall, Mississippi State, MS 39762 (jkc175@msstate.edu)

**Effects of brewing conditions on antioxidant capacity and phenolic contents of selected teas.** Sara Wetzstein<sup>1</sup>\* and Weiguang Yi<sup>2</sup>, <sup>1</sup> Oxford College, Emory University, 100 Hamill Street, Oxford, GA 30054, <sup>2</sup> Department of Horticulture, 1111 Miller Plant Science Bldg, University of Georgia, Athens, GA 30602, (abeyi@uga.edu)

### **NORMAN F. CHILDERS M.S. GRADUATE STUDENT PAPER COMPETITION**

**Room:** SBH Birmingham Ballroom V/IX  
**Presiding:** David Creech, President-Elect,  
Southern Region ASHS

**Abstracts:** To publish abstract in *HortScience*, see instructions at end of program. Submit on disk at meeting or email to Chair: (dcreech@sfasu.edu).

**9:30 am – 2:30 pm Order of presentations determined by drawing at beginning of contest.**

**Colored Shade Cloth Affects Growth of Basil, Cilantro, and Parsley.** Shawn Appling\*, John Freeborn, Joyce Latimer, Department of Horticulture,

301 Saunders Hall, Virginia Tech, Blacksburg, VA 24061-0327. (ashawn6@vt.edu).

**Development of genetic linkage map for blush in peach.** Terrence J. Frett<sup>1</sup>\*, Gregory L. Reighard<sup>1</sup>, Ksenija Gasic<sup>1</sup> and William Okie<sup>2</sup>. <sup>1</sup> School of Agricultural, Forest, and Environmental Sciences, Clemson University, E-143 Poole, Clemson, SC, 29634, <sup>2</sup>ARS-USDA, 21 Dunbar Rd., Byron, GA 31008 (terrencefrett@gmail.com).

**Dikegulac sodium enhances branching in herbaceous perennials during plug production.** Mara Grossman, John Freeborn, Holly Scoggins, and Joyce Latimer, Department of Horticulture, Virginia Tech, Blacksburg, Virginia 24061. (mgrossman@vt.edu).

**Evaluation of Eastern Red Cedar as an alternative amendment in the greenhouse production of annuals using a starter fertilizer.** Edwards, Lucy E.\* and Charles H. Gilliam. Department of Horticulture, Auburn University, Auburn, AL 36849. (lee0003@tigermail.auburn.edu).

**Evaluation of Selected American and French-American Hybrid Bunch Grape Cultivars in North Alabama.** Yilanna Hu<sup>1</sup>\*, Elina Coneva<sup>1</sup>, Edgar Vinson<sup>1</sup>, and Joyce Ducar<sup>2</sup>. <sup>1</sup>101 Funchess Hall, Department of Horticulture, Auburn University, AL, 36849, <sup>2</sup>13112 Alabama 68, Sand Mountain Research and Extension Center, Crossville, AL, 35962. (yzh0016@auburn.edu).

**Fungus Gnat Emergence in a Substrate Containing Cedar Wood Fiber.** Taylor A. Vandiver\*, Glenn B. Fain, Charles H. Gilliam, Jeff L. Sibley, David W. Held. Department of Horticulture, Auburn University, Auburn, AL 36849. (tav0001@tigermail.auburn.edu).

**Growth, photosynthesis, and water relations of young pecan seedlings in response to different nitrogen fertilization rates.** Hayley Hannah\*, Leonardo Lombardini, and Astrid Volder. Department of Horticulture Sciences, Texas A&M University, College Station, TX 77843-2133. (hhannah@neo.tamu.edu).

**Hardwood bark as a possible substrate component in annual production.** T.L. Weldon., G.B. Fain, J.L. Sibley and C.H. Gilliam. Department of Horticulture, Auburn University, Auburn, AL 36849. (Weldotl@auburn.edu).

**In Vitro Regeneration and Polyploid Induction of *Acer platanoides* L. ‘Crimson Sentry’.** Jason D. Lattier, Darren H. Touchell<sup>3</sup>, Thomas G. Ranney<sup>4</sup>.

Department of Horticultural Science, Mountain Horticultural Crops Research and Extension Center, North Carolina State University, 455 Research Drive, Mills River, NC 28759-3423. (jdlatter@gmail.com).

**Influence of Fruit Thinning and BenefitKiwi® on Fruit Size and Quality of 'AU Golden Dragon', 'AU Golden Sunshine', and 'Hort16A' Kiwifruit.** Jonathan Malone\*, James D. Spiers, William A. Dozier, Floyd M. Woods, Elina Coneva, Bryan S. Wilkins, 101 Funchess Hall, Department of Horticulture, Auburn University, Auburn, AL 36849. (malonjl@auburn.edu).

**Interspecific hybridization of Sweetpotato (*Ipomoea batatas* L.) with Morning Glory Species (*Ipomoea spp* L.).** Benjamin K. Winslow<sup>1\*</sup>, Shyamalrau P. Tallury<sup>2</sup>, and G. Craig Yencho<sup>1</sup>, <sup>1</sup>214-A Kilgore Hall, North Carolina State University, Raleigh, NC 27695-7609, <sup>2</sup>216 Method Unit 3, North Carolina State University, Raleigh, NC, 27695-7629. (ben\_winslow@ncsu.edu).

**Metabolomic profile of red raspberries grown in the southern US.** Christine Bradish<sup>1</sup>, Penelope Perkins-Veazie<sup>2</sup> and Gina Fernandez<sup>1</sup> <sup>1</sup>Department of Horticulture Science, 121 Kilgore Hall, North Carolina State University, Raleigh, NC 27695, <sup>2</sup>Plants for Human Health Institute, North Carolina State University, 600 Laureate Way, Kannapolis NC 28081. (cmbradis@ncsu.edu).

**Nitrogen fertilizer rate influences greenhouse sweetpotato plant production.** Chen Jiang\*, Zvezdana Pesic-VanEsbroeck and Jonathan R. Schultheis, North Carolina State University, Department of Horticultural Science, Box 7609, 2721 Founders Drive, Raleigh, NC 27695-7609. (cjiang5@ncsu.edu).

**Propagation of *Stevia Rebuadiana* stem cuttings influenced by media and cutting types.** LeCroy Jack M.\*, C.Coker, D.J. Eakes, C. Robinson, and J.L. Sibley. Department of Horticulture, Auburn University, Auburn, AL 36849. (jm10003@tigermail.auburn.edu).

**Propagation of *Vaccinium arboreum* by stem cuttings for use as a rootstock for commercial blueberries.** Jessica R. Bowerman<sup>1\*</sup>, James D. Spiers<sup>1</sup>, Elina Coneva<sup>1</sup>, Kenneth M. Tilt<sup>1</sup>, Eugene K. Blythe<sup>2</sup>, and Donna A. Marshall<sup>3</sup>. <sup>1</sup>Department of Horticulture, Auburn University, Auburn, AL 36849, <sup>2</sup>Mississippi State University, Coastal Research and Extension Center, South Mississippi Branch Experiment Station, P.O. Box 193, Poplarville, MS 39470, <sup>3</sup>USDA-ARS Southern Horticulture

Laboratory (SHL), 810 Highway 26 West, Poplarville, MS 39470. (jessbowerman@gmail.com).

**Saline Irrigation of Three Green Roof Species for the Southeast.** Judson S. LeCompte<sup>1\*</sup>, Amy N. Wright<sup>1</sup>, J. Raymond Kessler<sup>1</sup>, Charlene Lebleu<sup>2</sup>, <sup>1</sup>Department of Horticulture, 101 Funchess Hall, Auburn University, AL 36849, <sup>2</sup>Department of Landscape Architecture, 305 Dudley Hall, Auburn University, AL 36849. (js10009@auburn.edu).

**Transplant Holding Time and Environment Affects Yield and Stand of Sweetpotato.** William (Brad) B. Thompson\*, David W. Monks, Katharine M. Jennings and Jonathan R. Schultheis. North Carolina State University, Department of Horticultural Science, Box 7609, 2721 Founders Drive, Raleigh, NC 27695-7609 (brad\_thompson@ncsu.edu).

## WARREN S. BARHAM Ph.D. GRADUATE STUDENT PAPER COMPETITION

**Room:** SBH Birmingham Ballroom V/IX  
**Presiding:** David Creech, President-Elect, Southern Region ASHS

**Abstracts:** To publish abstract in *HortScience*, see instructions at end of program. Submit on disk at meeting or email to Chair: (dcreech@sfasu.edu).

**2:30 pm – 4:00 pm Order of presentations determined by drawing at beginning of contest.**

**Effects of fertilizer placement on trace gas emissions from container-grown plant production.** S. Christopher Marble<sup>1\*</sup>, Stephen A. Prior<sup>2</sup>, G. Brett Runion<sup>2</sup>, H. Allen Torbert<sup>2</sup>, Charles H. Gilliam<sup>1</sup>, Glenn B. Fain<sup>1</sup>, Jeff L. Sibley<sup>1</sup>, and Patricia R. Knight<sup>3</sup>. <sup>1</sup>101 Funchess Hall, Auburn University, Auburn, AL 36849, <sup>2</sup>USDA-ARS National Soil Dynamics Laboratory 411 S. Donahue Dr. Auburn, AL 36832, <sup>3</sup>Mississippi State Coastal Research and Extension Center, 1815 Popp's Ferry Road, Biloxi, MS 39532. (marblsc@auburn.edu).

**Evaluating the effect of selected fungicides on drought tolerance in tomatoes.** Diana R. Cochran<sup>1\*</sup>, Richard L. Harkess<sup>1</sup>, Patricia R. Knight<sup>2</sup>, Maria Tomaso-Peterson<sup>3</sup>, Eugene K. Blythe<sup>4</sup>, Charles H. Gilliam<sup>5</sup>, and Mengmeng Gu<sup>1</sup>. <sup>1</sup>117 Dorman Hall, Plant and Soil Sciences, Mississippi State University, Mississippi State, MS 39762, <sup>2</sup>1815 Popp's Ferry Road, Coastal Research and Extension Center, Mississippi State University, Biloxi, MS,

39532, <sup>3</sup>Entomology and Plant Pathology, Mississippi State University, Mississippi State University, MS, 39762, <sup>4</sup>PO Box 193, Coastal Research and Extension Center, Mississippi State University, Poplarville, MS 39470, <sup>5</sup>101 Funchess Hall, Auburn University, Auburn, AL 36849. (dc849@pss.msstate.edu).

**Photosynthetic rates of three diverse southeastern green roof species in response to drought and recovery.** Julie G. Price<sup>1\*</sup>, Amy N. Wright<sup>2</sup>, and Stephen A. Watts<sup>1</sup>, <sup>1</sup>1530 3<sup>rd</sup> Ave. S., Department of Biology, CH 464, University of Alabama at Birmingham, Birmingham, AL 35294-1170, <sup>2</sup>101 Funchess Hall, Department of Horticulture, Auburn University, Auburn, AL 36849. (juliegp@uab.edu).

**Storage and composition of organically grown blackberries.** <sup>1</sup>Moo Jung Kim, Penelope Perkins-Veazie<sup>2</sup> and Gina Fernandez<sup>1</sup> <sup>1</sup>Department of Horticulture Science, 121 Kilgore Hall, North Carolina State University, Raleigh, NC 27695, <sup>2</sup>Plants for Human Health Institute, North Carolina State University, 600 Laureate Way, Kannapolis NC 28081.(mkim10@ncsu.edu).

## EXTENSION SECTION

**Room:** MFCC Medical Forum D

**Presiding:** Lenny Wells

**Abstracts:** To publish abstract in *HortScience*, see instructions at end of program. Submit on disk at meeting or email to Chair: (lwells@uga.edu).

**8:00 One Particular Blogger: Two Years of the Grape Blog (Glog).** Eric T. Stafne<sup>1</sup>, <sup>1</sup>Plant and Soil Sciences Department, Mississippi State University, Box 193, Poplarville, MS 39470. (estafne@ext.msstate.edu).

**8:15 Louisiana Super Plants - A New Landscape Plant Promotion Program.** Allen Owings\*, Regina Bracy, and Dan Gill, LSU AgCenter, Hammond Research Station, 21549 Old Covington Highway, Hammond, LA 70403. (AOwings@agcenter.lsu.edu).

**8:30 After 12 Years: The Southeastern Vegetable Crops Handbook & SE Vegetable Extension Workers Meeting.** Joseph M. Kemble\*, George Boyhan, Jeanine Davis, Richard L. Hassell, Richard G. Snyder, and Annette Wszelaki, Department of Horticulture, Auburn University, Auburn, AL 36849-5408. (kembljm@auburn.edu).

**8:45 Using Life Cycle Assessment-based information in Extension.** Dewayne L. Ingram, University of Kentucky, N-308F Ag Science North, Lexington, KY 40546-0091. (dingram@email.uky.edu).

**9:00 Multisite Trap Cropping Demonstrations for Vegetable Insect Pest Management.** Ayanava Majumdar<sup>1\*</sup>, Robert Boozer<sup>2</sup>, Chris Becker<sup>3</sup>, James Miles<sup>4</sup>, and Randy Akridge<sup>5</sup>, <sup>1</sup> Gulf Coast Research and Extension Center, 8300 State Hwy 104, Fairhope, AL 36532, <sup>2</sup> Chilton Regional Research & Extension Center, 120 County Road 756, Clanton, AL 35045, <sup>3</sup> Alabama Cooperative Extension System, 802 Veterans Drive, Florence, AL 35630, <sup>4</sup> Alabama Cooperative Extension System, 1070 Schillinger Road N, Mobile, AL 36608, <sup>5</sup> Director, Brewton Agricultural Research Unit, 2067 Kirkland Road, Brewton, AL 36427. (azm0024@auburn.edu).

## EDUCATION SECTION

**Room:** MFCC Medical Forum C

**Presiding:** Carolyn Robinson

**Abstracts:** To publish abstract in *HortScience*, see instructions at end of program. Submit on disk at meeting or email to Chair: (cwrobinson@auburn.edu).

**3:00 Engaging Students via Outreach Programs in Urban Water Conservation.** Bodie Pennisi\*, Department of Horticulture, University of Georgia, 1109 Experiment St. CAES Griffin Campus, Griffin, GA 30223. (bpennisi@uga.edu).

**3:15 Building Better Peppers: An Experiential Learning in Plant Breeding for the Undergraduate Students.** Bala Rathinasabapathi\*, Horticultural Sciences Department, University of Florida, Gainesville, FL 32611-0690. (brath@ufl.edu).

**3:30 The Garden Program at Fayetteville School and Changes in School Ground Perceptions** Ann Fleener, Carolyn Robinson, J. Donald Eakes, Department of Horticulture, Auburn University, 101 Funchess Hall, Auburn, AL 36849. (awf0001@auburn.edu).



## POSTERS

**Room:** SBH Birmingham Prefunction  
**Presiding:** Thayne Montague  
**Abstracts:** To publish abstract in *HortScience*, see instructions at end of program. Submit on disk at meeting or email to Chair: (thayne.montague.ttu.edu).

**Set-Up:** Sunday, 8:00 am –12:00 pm  
**Poster Viewing** Sunday noon to Monday 10:30 am

**Authors at Poster:**  
 Sunday, 1:00 - 2:30 pm even numbered posters  
 Sunday, 2:30 - 4:00 pm odd numbered posters

**Students in Competition at Poster:**  
 Sunday, 1:00 - 2:30 pm even numbered posters  
 Sunday, 2:30 - 4:00 pm odd numbered posters

**Take-down:** Monday, 12:30 pm – 3:30 pm

### Student Poster Competition

“G” or “U” following the poster number indicates graduate and undergraduate poster, respectively, for the National Cowpea Poster Competition. Undergraduate and Graduate students in the poster competition must be by their poster at the appointed time listed above.

### Extension

1) **Non-traditional Community Garden Programs.** Christine E.H. Coker \*, Gary R. Bachman, Susan DeBlanc, and Corey Wheeler, Coastal Research and Extension Center, Mississippi State University, Biloxi, MS 39532. (ccoker@ra.msstate.edu).

### Floriculture, Ornamentals and Turf

2G) **Evaluation of Whole Tree Substrate Amended with Spent Mushroom Compost or Peat Moss in the Pot-In-Pot Production of *Rosa hybrid*.** Adam R. Summerville\* and Michael A. Maurer. Department of Agriculture, Stephen F. Austin State University, Nacogdoches, TX 75962-3000. (summerviar@titan.sfasu.edu).

3G) **Secondary Branch Angles and Potential Topophytic Effects of Vegetatively Propagated Clones of *Taxodium Rich*.** Andrew R. King\*<sup>1</sup>, Michael A. Arnold<sup>1</sup>, Douglas F. Welsh<sup>2</sup>, W. Todd Watson<sup>3</sup>, <sup>1</sup>Department of Horticultural Sciences, Texas A&M University, HFSB 201, College Station, TX 77843-2133, <sup>2</sup>Texas AgriLife Extension Service, Department of Horticultural Sciences, College Station, TX 77843-2134, <sup>3</sup>Department of Ecosystem Science and Management, Texas

A&M University, College Station, TX 77843-2138. (aking@tamu.edu).

4G) **Effects of Drought Stress on Greenhouse Grown Olives.** Vikram Baliga\*, Thayne Montague, and Cynthia Mckenney, Department of Plant and Soil Science, Texas Tech University, Lubbock, Texas, U.S.A. 79409-2122. (vikram.baliga@ttu.edu).

5) **Growth and development of Canna ‘Australia’ liners treated with florprimidol or paclobutrazal.** Michael A. Maurer\* and Adam R. Summerville, Department of Agriculture, Stephen F. Austin State University, Nacogdoches, TX 75962-3000. (maurerma@sfasu.edu).

6) **Homeowner Weed and Turf Identification Display.** Gary R. Bachman\*, Christine E.H. Coker, Susan DeBlanc, Corey Wheeler, and Patrick Broussard, Coastal Research and Extension Center, Mississippi State University, Biloxi, MS 39532. (gbachman@ext.msstate.edu).

7) **The Limited Effect of Fertilizer Type and Nutritional Status on Growth of *Salvia leucantha* during Drought and Heat Stress.** Andrea Grimsley\* and Derald A. Harp. Department of Agricultural Sciences. Texas A&M University – Commerce, Commerce, TX 75429. (agrimley@leo.tamu-commerce.edu).

8) **The Role of Substrate and Environment in Early Seedling Growth in *Rhododendron calendulaceum*.** Eric J. Limbird\* and Nathan C. Phillips, School of Agribusiness and Agriscience, Middle Tennessee State University, Murfreesboro, TN 37132. (ejl2t@mtmail.mtsu.edu).

9) **Water Use and Growth of Three *Viburnum* Species under Three Shade Intensities.** Arjina Shrestha and Janet C. Cole\*, Department of Horticulture and Landscape Architecture, Oklahoma State University, Stillwater, OK 74078-6027. (janet.cole@okstate.edu).

### Fruit Crops

10) **A Pruning Method for Enhancing Yield of Muscadine Grape (*Vitis rotundifolia*, Michx.) Cultivars in Home Vineyards.** Stephen J. Stringer\*, Donna A. Marshall, Ned C. Edwards, and Blair J. Sampson. USDA-ARS Southern

- Horticulture Laboratory, Poplarville, MS, 39470. (Stephen.Stringer@ars.usda.gov).
- 11) **Effect of Extreme Heat and Drought on Rabbiteye Blueberry (*Vaccinium virgatum*) Yields in Northeast Texas.** Charle Blackburn\*, Jim Heitholt, and Derald A. Harp. Department of Agricultural Sciences. Texas A&M University – Commerce, Commerce, TX 75429. (cblackburn@leo.tamu-commerce.edu).
  - 12) **Establishment of Pierce’s Disease Resistant *Vitis vinifera* Grapes in Alabama.** Elina Coneva\*<sup>1</sup>, Edgar Vinson<sup>1</sup>, and James Pitts<sup>2</sup>. <sup>1</sup>101 Funchess Hall, Department of Horticulture, Auburn University, AL 36849, <sup>2</sup>Chilton Research and Extension Center, 120 Co. Rd. 756, Clanton, AL, 35045. (Edc0001@auburn.edu).
  - 13) **Evaluation of Table Grape Selections in Alabama.** Elina D. Coneva\*<sup>1</sup>, Yilanna Hu<sup>1</sup>, Edgar Vinson<sup>1</sup>, and A. W. Caylor<sup>2</sup>, <sup>1</sup>101 Funchess Hall, Department of Horticulture, Auburn University, AL 36849, <sup>2</sup>Alabama Agricultural Experiment Station, P.O. Box 1062, Cullman, AL 35056. (edc0001@auburn.edu).
  - 14) **Gas Exchange of Drought Stressed Greenhouse Grown Olive Variety’s.** Thayne Montague\*, Vikram Baliga, and Cynthia Mckenney, Department of Plant and Soil Science, Texas Tech University, Lubbock, Texas, U.S.A. 79409-2122. (thayne.montague@ttu.edu).
  - 15) **Incidence of *Xylella Fastidiosa* in Commercial Blueberry Orchards in Alabama.** Elina D. Coneva\*<sup>1</sup>, J.F. Murphy<sup>2</sup>, and Edgar Vinson<sup>1</sup>, <sup>1</sup>101 Funchess Hall, Department of Horticulture, Auburn University, AL 36849, <sup>2</sup>209 Life Sciences Building, Department of Entomology and Plant Pathology, Auburn University, Auburn, AL 36849. (edc0001@auburn.edu).
  - 16) **Peach Rootstock Trial in Alabama.** Elina Coneva\*<sup>1</sup> and James Pitts<sup>2</sup>. <sup>1</sup>101 Funchess Hall, Department of Horticulture, Auburn University, AL 36849, <sup>2</sup>Chilton Research and Extension Center, 120 Co. Rd. 756, Clanton, AL, 35045. (Edc0001@auburn.edu).
  - 17) **Physiological Differences Five Grapevine Varieties Grown on the Texas High Plains.** Thayne Montague\*, Edward Hellman, and Keith Jenkins. Texas AgriLife Research and Extension Center, Lubbock, Texas, U.S.A. 79403-6603. (thayne.montague@ttu.edu).
  - 18) **Preemergence Herbicide Screening for Weed Control in Grapes.** Eric T. Stafne<sup>1</sup>, Lynn Brandenberger<sup>2\*</sup>, Lynda Carrier<sup>2</sup>, and Becky Carroll<sup>2</sup>, <sup>1</sup>Plant and Soil Sciences Department, Mississippi State University, Box 193, Poplarville, MS 39470, <sup>2</sup>358 Ag Hall, Department of Horticulture and Landscape Architecture, Oklahoma State University, 74078. (lynbradenberger@okstate.edu).
  - 19) **Response of Greenhouse Grown Olive Varieties to Irrigation and Fertilization Regimes.** Kaylee Decker, Cynthia Mckenney and Thayne Montague\*, Department of Plant and Soil Science, Texas Tech University, Lubbock, Texas, U.S.A. 79409-2122. (thayne.montague@ttu.edu).
  - 20) **Seasonal and Regional Variations in Antioxidant Components of Selected Rabbiteye Blueberry Cultivars Grown in Alabama.** F. M. Woods\*<sup>1</sup>, E. Coneva<sup>1</sup>, K. Shetty<sup>2</sup>, D. Sarkar<sup>2</sup>, G. Miakonkana<sup>3</sup>, A. Gebrekidan<sup>3</sup>, A. Caylor<sup>4</sup>, E. L. Vinson<sup>1</sup>, and B.D. Blasius<sup>1</sup>. <sup>1</sup>101 Funchess Hall, Department of Horticulture, Auburn University, AL 36849, <sup>2</sup>100 Holdsworth Way, Department of Food Science, University of Massachusetts, Amherst, Massachusetts, <sup>3</sup>221 Parker Hall, Mathematics and Statistics, Auburn, University, 36849, <sup>4</sup>Alabama Agriculture Experiment Station, 765 County Rd. 1466, Cullman, AL 35055. (woodsfm@acesag.auburn.edu).
  - 21) **Influence of pH and Provenance on Growth of *Vaccinium arboreum*.** Jonathan Meador<sup>1\*</sup>, James Spiers<sup>1</sup>, Elina Coneva<sup>1</sup>, Jeff Sibley<sup>1</sup>, Rebecca Darnell<sup>2</sup>, <sup>1</sup> Auburn University Horticulture Department, 101 Funchess Hall, Auburn University, Auburn, AL 36849, <sup>2</sup> Horticultural Sciences Department 1131 Fifield Hall, P.O. Box 110690 Gainesville, FL 32611, (meadojc@auburn.edu)
- Vegetable Crops**
- 22U) **Antioxidant capacity and phenolic profiles of some regular and decaffeinated teas.** Sara Wetzstein<sup>1\*</sup> and Weiguang Yi<sup>2</sup>, <sup>1</sup> Oxford College, Emory University, 100 Hamill Street, Oxford, GA 30054, <sup>2</sup> Department of Horticulture, 1111 Miller Plant Science Bldg, University of Georgia, Athens, GA 30602. (abeyi@uga.edu).

- 23) **Consumer Demand and Preference for Fresh Lotus Root.** S.R. Sand<sup>1</sup>, D. Fields<sup>1\*</sup>, F.M. Woods<sup>2</sup>, A.N. Wright<sup>2</sup>, K.M. Tilt<sup>2</sup>, T.S. Huang<sup>3</sup>, <sup>4</sup>L.Y. Man, <sup>4</sup>L. Yiman, and <sup>4</sup>K. W. Dong. <sup>1</sup>100 Comer Hall, Department of Agriculture Economics, Auburn University, AL 36849, <sup>2</sup>101 Funchess Hall, Department of Horticulture, Auburn University, <sup>3</sup>260 Lem Morrison Drive, Department of Poultry Science, Auburn University, <sup>4</sup>Wuhan Vegetable Research Institute, Wuhan, Hubei Province, P.R. China. (fielded@auburn.edu).
- 24) **Effect of Container Size on the Growth and Development of Edible Lotus (*Nelumbo nucifera* cv. E2) in Central Alabama.** X. Wang<sup>\*1</sup>, F.M.Woods<sup>1</sup>, K.M. Tilt<sup>1</sup>, K. Shetty<sup>2</sup>, D. Sarkar<sup>2</sup>, T.S. Huang<sup>3</sup>, <sup>4</sup>L.Y. Man, <sup>4</sup>L. Yiman, <sup>4</sup>K. W. Dong, and B. Blasius<sup>1</sup>, <sup>1</sup>101 Funchess Hall, Department of Horticulture, Auburn University, AL 36849. <sup>2</sup>100 Holdsworth Way, Department of Food Science, University of Massachusetts, Amherst, Massachusetts, <sup>3</sup>260 Lem Morrison Drive, Department of Poultry Science, Auburn University, AL 36849, <sup>4</sup>Wuhan Vegetable Research Institute, Wuhan, Hubei Province, P.R. China. (woodsfm@auburn.edu).
- 25) **Evaluation of Cucurbit Rootstocks for Grafting in Triploid Watermelon (*Citrullus lanatus*) Production for Southwestern Indiana.** Shubin K. Saha<sup>1\*</sup> and Dan Egel<sup>2</sup>, <sup>1</sup>Horticulture and Landscape Architecture Department, <sup>2</sup>Botany and Plant Pathology Department, Southwest Purdue Ag Program, Purdue University, Vincennes, IN 47591. (ssaha@purdue.edu).
- 26) **External Indicators Predict Maturity in Fruit of ‘Valdoria’ and ‘Vanessa’ Mini-watermelon.** Edgar L. Vinson, III<sup>\*</sup>, Joseph M. Kemble, and Floyd Woods, Department of Horticulture, Auburn University, Auburn, AL 36849-5408. (vinsoed@auburn.edu).
- 27) **Growth and Yield Response of Four Tomato Varieties in the US Virgin Islands.** Dilip Nandwani<sup>1\*</sup>, Thomas Zimmerman<sup>1</sup>, Vanessa Forbes<sup>1</sup> and Stafford Crossman<sup>2</sup>, <sup>1</sup>Agricultural Experiment Station, University of the Virgin Islands, Kingshill VI 00850, <sup>2</sup>Cooperative Extension Service, University of the Virgin Islands, Kingshill, VI. 00850. (dnandwa@uvi.edu).
- 28) **Gypsum application improves both soil attributes and broccoli floret total sulfur concentrations.** D. J. Makus<sup>\*</sup>, USDA-ARS Subtropical Agricultural Research Center, Weslaco, TX 78596. (donald.makus@ars.usda.gov).
- 29) **Influence of Time of Harvest and Development of Maturity Index in Lotus (*Nelumbo spp.*) and Antioxidant Properties.** P. X. Wang<sup>\*1</sup>, F.M.Woods<sup>1</sup>, K.M. Tilt<sup>1</sup>, K. Shetty<sup>2</sup>, D. Sarkar<sup>2</sup>, T.S. Huang<sup>3</sup>, <sup>4</sup>L.Y. Man, <sup>4</sup>L. Yiman, <sup>4</sup>K. W. Dong, B. Blasius<sup>1</sup>, and R. Shevade<sup>1</sup>. <sup>1</sup>101 Funchess Hall, Department of Horticulture, Auburn University, AL 36849. <sup>2</sup>100 Holdsworth Way, Department of Food Science, University of Massachusetts, Amherst, Massachusetts, <sup>3</sup>260 Lem Morrison Drive, Department of Poultry Science, Auburn University, AL 36849, <sup>4</sup>Wuhan Vegetable Research Institute, Wuhan, Hubei Province, P.R. China. (woodsfm@auburn.edu).

## Monday, February 6, 2012

### POSTERS

**Room:** SBH Birmingham Prefunction  
**Presiding:** Thayne Montague  
**Abstracts:** To publish abstract in *HortScience*, see instructions at end of program. Submit on disk at meeting or email to Chair: (thayne.montague.ttu.edu)  
**Poster Viewing** Monday 8:00-10:30 am  
**Take-down:** Monday, 12:30 pm – 3:30 pm

### ANNUAL BUSINESS MEETING AND AWARDS PROGRAM

**Room:** MFCC Medical Forum Auditorium  
**Time:** 11:00 – 12:30  
**Presiding:** Brian Kahn, President

### VEGETABLE CROPS SECTION

**Room:** BJCC East Meeting Room F  
**Presiding:** Juan Diaz-Perez  
**Abstracts:** To publish abstract in *HortScience*, see instructions at end of program. Submit on disk at meeting or email to Chair: (jcdiaz@uga.edu).

#### Morning Session

- 8:00 Evaluation of Early Nitrogen Rates for Strawberry Cultivars.** Bielinski M. Santos. Department of Horticultural Sciences, University of Florida, Gulf Coast REC, 14625 CR 672 Wimauma, FL 33598. (tsalame@ufl.edu).
- 8:15 The Effects of Organic Fertilizers on Suppression of *Pythium aphanidermatum* in Tomato Plants.** Yan Ma<sup>1\*</sup>, Maria Tomaso-Peterson<sup>2</sup>, and Mengmeng Gu<sup>3</sup>. <sup>1</sup>Jiangsu Academy of Agricultural Sciences, 50 Zhongling Street, Nanjing, China 210014; <sup>2</sup>Department of Plant Pathology, Mississippi State University, Box 9655, Mississippi State, MS 39762; <sup>3</sup>Department of Horticultural Sciences, 225 Horticulture/Forestry Sciences Building 2134, Texas A&M University, College Station, Texas 77843-2134. (myjaas@sina.com).
- 8:30 Potential of Broiler Litter and a Fish-Protein Based Fertilizer as Organic**

**Amendments for Several Specialty and Exotic Vegetable Crops.** Loutrina Staley and Desmond G. Mortley. G.W. Carver Agricultural Experiment Station and Department of Agricultural and Environmental Sciences, Tuskegee University, Tuskegee AL 36088. (mortleyd@mytu.tuskegee.edu).

- 8:45 Comparison of Potassium Sources and Rates for Tomato Production in Florida Sandy Soils.** Bielinski M. Santos. Department of Horticultural Sciences, University of Florida, Gulf Coast REC, 14625 CR 672 Wimauma, FL 33598. (bmsantos@ufl.edu).

#### 9:00 Break

- 9:15 Evaluation of Nitrogen Rates for Tomato and Bell Pepper Growth and Yield under Protected Culture.** Emmanuel A. Torres-Quezada\*, Teresa P. Salame-Donoso, Carlos J. Mendez-Urbaz and Bielinski M. Santos. Department of Horticultural Sciences, University of Florida, Gulf Coast REC, 14625 CR 672 Wimauma, FL 33598 (bmsantos@ufl.edu).
- 9:30 Eggplant Yield as Affected by Drip Irrigation Rates.** Juan Carlos Díaz-Pérez<sup>1\*</sup> and Touria El-Jaoual<sup>2</sup>. <sup>1</sup>Department of Horticulture, University of Georgia, Tifton, GA 31793; <sup>2</sup>Department of Plant, Soil & Insect Sciences, University of Massachusetts, Amherst, MA 01003.
- 9:45 Plant Growth and Yield of Kale Cultivars Under Plastic Film Mulch.** Juan Carlos Díaz-Pérez<sup>1\*</sup>, Smiljana Goreta Ban<sup>2</sup>, Daniel Maclean<sup>3</sup>, Gvozden Dumičić<sup>2</sup>, Branimir Urlic<sup>2</sup>, Sarah Workman<sup>4</sup>. <sup>1</sup>Department of Horticulture, University of Georgia, Tifton, GA 31793; <sup>2</sup>Institute for Adriatic Crops, Put Duilova 11, 21 000 Split, Croatia; <sup>3</sup>AgroFresh, 620 Cantrill Drive, Davis CA 95618; <sup>4</sup>Warnell School and CAES Center for Agribusiness & Economic Development, University of Georgia, Athens, GA 30602
- 10:00 Effects of Grafting on Plant Growth, Yield and Fruit Quality of Seven Different Genotypes of Melons.** Richard L. Hassell, Clemson University CREC, 2700 Savannah Highway, Charleston, SC. 29414. (rhassel@clemson.edu).
- 10:15 Extended season leafy greens for health and wealth: A report on cool season leafy**

**greens production trials in high tunnels.** L. Brandenberger<sup>1\*</sup>, B. Kahn<sup>1</sup>, S. Gray<sup>2</sup>, J. Shrefler<sup>3</sup>, W. Roberts<sup>3</sup>, M. Taylor<sup>3</sup>, S. Upson<sup>4</sup>, C. Rohla<sup>4</sup>, J. Laughlin<sup>5</sup>, <sup>1</sup>358 Ag Hall, Stillwater, OK 74078, <sup>2</sup>4116 E. 15<sup>th</sup>, Tulsa, OK 74112, <sup>3</sup>P.O. Box 128, Lane, OK 74555, <sup>4</sup>2510 Sam Noble Parkway, Ardmore, OK 73401, <sup>5</sup>400 N. Portland Oklahoma City, OK 73107. (lynn.brandenberger@okstate.edu).

**11:00 – 12:30 Attend Business Meeting and Awards Program**

**Afternoon Session**

- 1:00 Water uptake, yield and fruit quality of specialty melons (*Cucumis melo* L.) under deficit irrigation.** Sat Pal Sharma<sup>1\*</sup>, Daniel I. Leskovar<sup>1</sup>, Kevin M. Crosby<sup>2</sup> and Astrid Volder<sup>2</sup>, <sup>1</sup>Texas Agrilife Research and Extension Center, 1619 Garner Field Road, Uvalde, TX 78801, <sup>2</sup>Department of Horticultural Sciences, Texas A&M University, College Station, TX 77843-2133. (sharma145@neo.tamu.edu).
- 1:15 Toward Genetic Improvement of Peppers for Desirable Colors, Antioxidants and Flavors: The Use of Heirloom Varieties.** Ann M. Green\*, Steve Sargent and Bala Rathinasabapathi, Horticultural Sciences Department, University of Florida, Gainesville, FL 32611-0690. (agreene175@ufl.edu).
- 1:30 Optimizing Abscisc Acid Foliar Application for Size Control of Pepper and Watermelon Transplants.** Shinsuke Agehara\* and Daniel I. Leskovar, Texas AgriLife Research, Department of Horticultural Sciences, Texas A&M University, Uvalde, TX 78801. (shinsuke.agehara@gmail.com).
- 1:45 ABA and Tray Cell Volume Impact Transplant Height in Bell Pepper Seedlings.** Chris Gunter. Department of Horticultural Science, North Carolina State University, 230 Kilgore Hall, Box 7609, Raleigh, NC 27695-7609. (cgunter@ncsu.edu).
- 2:00 Winners from Two Years of Summer Cover Crop Screening in Mississippi and Louisiana.** W.B. Evans<sup>1</sup>, C. Motsenbocker<sup>2</sup>, R. Mentreddy<sup>3</sup>, G. Panicker<sup>4</sup>, and V.

Cerven<sup>1</sup>. <sup>1</sup>Mississippi State University Truck Crops Branch, P.O. Box 231, Crystal Springs, MS 39059, <sup>2</sup>School of Plant, Environmental, and Soil Sciences, Louisiana State University Agricultural Center, Baton Rouge, LA 70803, <sup>3</sup>Dept. of Biological and Environmental Sciences, Alabama A&M University, AL 35763, <sup>4</sup>School of AREAS, Alcorn State University, Alcorn State, MS 39096. (wbe@ra.msstate.edu).

**FRUIT CROPS SECTION**

**Room: BJCC East Meeting Room I**

**Presiding: Jay Spiers**

**Abstracts:** To publish abstract in *HortScience*, see instructions at end of program. Submit on disk at meeting or email to Chair: (jds0017@auburn.edu).

**Morning Session**

- 8:00 Yield and Quality of Selected Rabbiteye Blueberry (*Vaccinium ashei*) Cultivars.** Elina D. Coneva<sup>\*1</sup>, J. Sibley<sup>1</sup>, J. Spiers<sup>1</sup>, and A.W. Caylor<sup>2</sup>. <sup>1</sup>101 Funchess Hall, Department of Horticulture, Auburn University, AL 36849, <sup>2</sup>North Alabama Horticulture Research Center, 765 County Road 1466, Cullman, AL 35055. (edc0001@auburn.edu).
- 8:15 Performance of blueberry cultivars under high tunnels.** Teresa P. Salame-Donoso\* and Bielinski M. Santos, Gulf Coast Research and Education Center, IFAS, University of Florida, 14625 CR 672, Wimauma, FL 33598. (tsalame@ufl.edu).
- 8:30 Status of China's Developing Blueberry Industry.** David Creech\*, Department of Agriculture, Stephen F. Austin State University, P.O. Box 13000, SFA Station, Nacogdoches, TX 75962. (dcreech@sfasu.edu).
- 8:45 Improving yield and berry quality for zygomorphic blooms of blueberry: the role of the plant growth regulators, gibberellic acid and coconut oil.** Donna A. Marshall\*, B.J. Sampson, S.J. Stringer, and H Sakhanoiko. USDA-ARS Thad Cochran Southern Horticultural Laboratory, Poplarville, MS 39470. (Donna.Marshall@ars.usda.gov).

**9:00 Evaluation of fresh market peaches and nectarines for improved harvest and storage performance characteristics.** John R. Clark<sup>1\*</sup>, Paul J. Sandefur<sup>1</sup>, and Cameron P. Peace<sup>2</sup>. <sup>1</sup>316 Plant Science, Department of Horticulture, University of Arkansas, Fayetteville, AR 72701, <sup>2</sup>39 Johnson Hall, Department of Horticulture and Landscape Architecture, Washington State University, Pullman, WA 99164. (jrclark@uark.edu).

**9:15 Break**

**9:30 Effect of Self- and Cross-pollination on Fruit Set and Fruit Quality in Pomegranate (*Punica granatum* L.).** Hazel Y. Wetzstein<sup>1\*</sup>, Weiguang Yi<sup>1</sup>, and Nadav Ravid<sup>2</sup>, <sup>1</sup>Department of Horticulture, University of Georgia, Athens, GA 20602, <sup>2</sup>Paramount Farming Company, 33141 E. Lerdo Hwy, Bakersfield, CA 93308. (hywetz@uga.edu).

**9:45 Susceptibility of *Prunus* Rootstock Cultivars to Peach Tree Short Life in South Carolina.** Gregory L. Reighard\*, David R. Ouellette and Kathy H. Brock, School of Agricultural, Forestry and Environmental Sciences, Clemson, University, Clemson, SC 29634. (grghrd@clemson.edu).

**10:00 Influence of Nitrogen Fertilization Rates on Satsuma Mandarin Yield, Fruit Quality, and Growth.** Jay D. Spiers\*<sup>1</sup>, Bryan Wilkins<sup>1</sup>, and Larry Wells<sup>2</sup>, <sup>1</sup>101 Funchess Hall, Department of Horticulture, Auburn University, AL 36849, <sup>2</sup>167 East Alabama Highway 134, Headland, AL 36345.

**10:15 Extending strawberry season production and cultivar evaluation for Arkansas.** M. Elena Garcia\*, Christopher I. Vincent, and David Dickey. Horticulture Dept., University of Arkansas, Fayetteville, AR 72701. (megarcia@uark.edu).

**11:00 – 12:30 Attend Business Meeting and Awards Program**

**Afternoon Session**

**1:00 Assessment of pecan industry in Arkansas.** M. Elena Garcia\* and David Dickey, Horticulture Dept., University of Arkansas, Fayetteville, AR 72701. (megarcia@uark.edu).

**1:15 Evaluation of Fresh Dug Strawberry Plants as an Alternative Method of Establishing Hoop House (High Tunnel) Strawberry**

**Crops in Oklahoma.** C. Rohla, and S. Upson, 2510 Sam Noble Parkway, Ardmore, OK 73401, (ctrohla@noble.org)

**1:30 NC 430, a promising thornless erect blackberry selection from North Carolina State University;** J. R. Ballington, and G. Fernandez. Horticultural Science Department, Box 7609, North Carolina State University, Raleigh, NC 27695-7609 (jrbrsb@ncsu.edu)

## FLORICULTURE, ORNAMENALS AND TURF SECTION

**Room:** BJCC East Meeting Room G

**Presiding:** Paul A. Thomas

**Abstracts:** To publish abstract in *HortScience*, see instructions at end of program. Submit on disk at meeting or email to Chair: (pathomas@uga.edu).

**Morning Session**

**8:00 The Effect of Salinity Stress on *Miscanthus* and *Pennisetum* Cultivars.** Jianquin Gao\*, and MengMeng Gu, <sup>1</sup> Jiangsu Academy of Agricultural Sciences, 50 Zhongling Street, Nanjing, China 210014. <sup>2</sup>Department of Horticultural Sciences, 225 Horticulture/Forestry Sciences Building, 2134 Texas A&M University, College Station, Texas. 77843-2134. (chinagjq@163.com)

**8:15 Planting Date and Fertilization Affect *Scaevola* Performance in the Landscape.** Yan Chen\*, Allen Owings, and Regina Bracy, Hammond Research Station, 21549 Old Covington Highway, Hammond, LA 70403. (yanchen@agcenter.lsu.edu)

**8:30 Media CO<sub>2</sub> Flux in a Texas Extensive Green Roof.** Derald A. Harp\* and Chris Dunlap, Department of Agricultural Sciences. Texas A&M University – Commerce, Commerce, TX 75429. (Derald\_Harp@TAMU-Commerce.edu)

**8:45 SFA Garden Survivors of the Texas Drought of 2010 and 2012.** David Creech\*, Stephen Austin State University, Department of Agriculture, P.O. Box 13000, Nacogdoches, TX 75962. (dchreech1@hotmail.com)

**9:00 Break**

- 9:15 Colored Shade Cloth Affects Growth of Basil, Cilantro, and Parsley.** Shawn Appling\*, John Freeborn, Joyce Latimer, Department of Horticulture, 301 Saunders Hall, Virginia Tech, Blacksburg, VA 24061-0327. (ashawn6@vt.edu)
- 9:30 Dikegulac Sodium Enhances Branching in Herbaceous Perennials During Plug Production.** Mara Grossman\*, John Freeborn, Holly Scoggins, and Joyce Latimer, Department of Horticulture, Virginia Tech, Blacksburg, VA 24061. (mgrossman@vt.edu)
- 9:45 On-The-Go Caliper and Counter Device for Shade and Fruit Tree Nursery Inventory Management.** J. Owen\*, S. Singh, W. Shi, H. Stoven, K. Lewis, S. Doane, M. Bergman, Virginia Polytechnic Institute and State University Hampton Roads Agricultural Research and Extension Center, 1444 Diamond Springs Road, Virginia Beach, VA 23455. (nsy.prod@vt.edu)
- 10:00 Development of an Inventory Management Tool for Nurseries Using an Unmanned Aerial Platform.** J. Owen\*, J. Robbins, R. Ehsani, D. Saraswat, J. Maja, H. Stoven, S. Doane, C. Landgren, Virginia Polytechnic Institute and State University. Hampton Roads Agricultural Research and Extension Center, 1444 Diamond Springs Road, Virginia Beach, VA 23455. (nsy.prod@vt.edu)
- 10:15 Evaluating a More Sustainable Controlled Release Fertilizer for Ornamental Crops using a Struvite Byproduct from Wastewater Treatment.** J. Owen\*, H. Stoven, J. Altland, J. Albano, Virginia Polytechnic Institute and State University. Hampton Roads Agricultural Research and Extension Center. 1444 Diamond Springs Road, Virginia Beach, VA 23455. (nsy.prod@vt.edu)
- 1 0:30 Using Plantable Containers for Selected Ground-cover Plant Production.** Dewayne L. Ingram\* and Susmitha S. Nambuthiri, N-308F Ag Science North, University of Kentucky. Lexington, KY 40546-0091. (dingram@email.uky.edu).
- 11:00 – 12:30 Attend Business Meeting and Awards Program**
- Afternoon Session:**
- 1:00 Home Gardener, Master Gardener and Green Industry Professional Selections from the Trial Gardens at the LSU Ag Center – 2011.** Allen Owing\*, Yan Chen, Regina Bracy, Roger Rosendale, and Joey Quebedeaux. LSU Ag Center. Hammond Research Station, 21549 Old Covington Highway, Hammond, LA 70403. (aowings@agcenter.lsu.edu)
- 1:15 Cold Hardiness of Colocasia and Alocasia Species and Cultivars (Elephant Ears).** Bodie Pennisi\* and Orville Lindstrom, Department of Horticulture, University of Georgia, 1109 Experiment St. CAES Griffin Campus, Griffin, GA 30223 (bpennisi@uga.edu)
- 1:30 Use of Controlled Water Deficit to Control Height of Poinsettias.** Alem Peter\*, Paul Thomas and Marc van Iersel, 1111 Miller Plant Science Building, The University of Georgia, Athens, GA 30602. (mvanier@uga.edu)
- 1:45 A Comparison of ABA and ABA-analog Prays for Reducing Transpiration in Pansies.** Geoffrey Weaver\* and marc van Iersel. 1111 Miller Plant Science Building, The University of Georgia, Athens, GA 30602. (mvanier@uga.edu)
- 2:00 Break**
- 2:15 Water Consumption of *Gardenia jasminoides* and *Hydrangea macrophylla* as Affected by Environmental Factors.** Lucas O'Meara\*, Matthew Chappell, John Ruter and Marc van Iersel\*, 1111 Miller Plant Science Building, The University of Georgia, Athens, GA 30602. (mvanier@uga.edu)
- 2:30 Growth and Water use of Two *Gardenia* Species in Response to Substrate Water Content-based Irrigation.** Mandy Bayer\*, Lucas O'Meara, Alem Peter, Paul Thomas, Matthew Chappell, John Ruter and Marc van Iersel, 1111 Miller Plant Science Building, The University of Georgia, Athens, GA 30602. (mvanier@uga.edu)
- 2:45 Wireless Sensor Networked for Automated Irrigation Control in Greenhouses and Nurseries.** Marc van Iersel\*, Mandy Bayer, Lucas O'Meara, Alem Peter, Paul Thomas, Matthew Chappell, John Ruter and Sheryl Wells, 1111 Miller Plant Science Building, The University of Georgia, Athens, GA 30602. (mvanier@uga.edu)

**3:00 Hardwood Mulch as a Weed Suppressant for Bittercress.** Anna-Marie Murphy\*, Charles H. Gilliam, and S. Chris Marble, 101 Funchess Hall, Department of Horticulture, Auburn University, AL 36849. (murphan@auburn.edu).

**3:15 Use of Auxin and Wounding Treatments for Hardwood Cutting Propagation of *Hibiscus mutabilis*.** Eugene K. Blythe\*, Coastal Research and Extension Center, Mississippi State University, South Mississippi Branch Experiment Station, Poplarville, MS 39470. (blythe@pss.msstate.edu)

## POST HARVEST/PLANT BIOTECHNOLOGY SECTION

**Room:** BJCC East Meeting Room H

**Presiding:** David Picha

**Abstracts:** To publish abstract in *HortScience*, see instructions at end of program. Submit on disk at meeting or email to Chair: (dpicha1@lsu.edu).

**8:00 Carbohydrate changes in sweetpotato roots during curing.** D.H. Picha\* and M. S. Bowen. School of Plant, Environmental and Soil Sciences, Louisiana State University, Baton Rouge, LA 70803. (dpicha1@lsu.edu).

**8:15 Controlled atmosphere regulation of sweetpotato composition.** D.H. Picha\* and M. S. Bowen. School of Plant, Environmental and Soil Sciences, Louisiana State University, Baton Rouge, LA 70803. (dpicha1@lsu.edu).

**8:30 Developing a protocol for rating storage life of muscadine grapes.** P. Perkins-Veazie. Plants for Human Health Institute, North Carolina State University, Kannapolis, NC 28081. (penelope\_perkins@ncsu.edu).

**8:45 Carotenoid content of raspberries and blackberries.** P. Perkins-Veazie. Plants for Human Health Institute, North Carolina State University, Kannapolis, NC 28081. (penelope\_perkins@ncsu.edu).

**9:00 Raspberries fruit flavonoids differ with germplasm and production environment in the southern U.S.** C. Bradish\*, P. Perkins-Veazie, and G. Fernandez. Department of Horticulture, North Carolina State University, Raleigh, NC 27695. (cmbradis@ncsu.edu).

**9:15 Composition of organically grown blackberries.** M. Jung Kim\*, P. Perkins-Veazie, and G. Fernandez. Department of Horticulture, North Carolina State University, Raleigh, NC 27695. (mkim10@ncsu.edu).

**11:00 – 12:30 Attend Business Meeting and Awards Program**

## WORKING GROUPS

(Contact Chairs for Agenda and Presentation times)

### Sweet Potato SCRI Project

**Presiding:** Tara Smith  
(tsmith@agcenter.lsu.edu)

**Friday:** 8:00 am – 5:00 pm

**Room:** MFCC Medical Forum A

### National Sweet Potato Collaborators Group

**Presiding:** Ramon Arancibia  
(raa66@msstate.edu)

**Saturday:** 8:00 am – 5:00 pm

**Room:** MFCC Medical Forum A

### Sweetpotato Production, Physiology, and Plant/Seed Production

**Presiding:** Jonathan Schultheis (North Carolina State University) (jonr@ncsu.edu).

**9:00 Plant and Harvest Times, and Overhead Irrigation and their Influence on Sweetpotato Yields.** Jonathan R. Schultheis\* and William (Brad) B. Thompson, North Carolina State University, Dept. Horticultural Science, Box 7609, Raleigh, NC 27695-7609. (jonathan\_schultheis@ncsu.edu).

**9:15 Determining the water requirements of drip-irrigated sweetpotatoes in California.** Scott Stoddard<sup>1\*</sup>, Bob Weimer<sup>2</sup> and Larry Schwankle<sup>3</sup>, <sup>1</sup>University of California Cooperative Extension, 2145 Wardrobe Ave., Merced, CA 94301; <sup>2</sup>Weimer Farms, 5120 N. Arena Way, Atwater CA 95301; <sup>3</sup>University of California Cooperative Extension, Kearney Ag Center, 9240 S. Riverbend Ave., Parlier, CA 93648. (csstoddard@ucdavis.edu).

**9:30 Drip-Irrigation, Plant Spacing and Time of Harvest Influence Sweetpotato Marketable Yield.** Ramon A. Arancibia\* and Jeff Main, Pontotoc Ridge-Flatwoods Branch Experiment



Station, North Mississippi Research and Extension Center, Mississippi State University, Pontotoc, MS 38863. (raa66@msstate.edu).

**9:45 Changes in Phenolic Content in Sweetpotato Subjected to Water Stress and Virus Infections.** Ramon A. Arancibia, Xiang Wang\*, Jeff Main, and Mark Shankle, Pontotoc Ridge-Flatwoods Branch Experiment Station, North Mississippi Research and Extension Center, Mississippi State University, Pontotoc, MS 38863. (raa66@msstate.edu).

**10:00 Lateral root density is associated with anomalous cambium development in 'Beauregard' sweetpotato adventitious roots.** Arthur Villordon<sup>1\*</sup>, Don LaBonte<sup>2</sup>, Julio Solis<sup>2</sup>, and Nurit Firon<sup>3</sup>, <sup>1</sup>LSU AgCenter Sweet Potato Research Station, Chase, La 71324 USA; <sup>2</sup>LSU AgCenter School of Plant, Environmental, and Soil Sciences, 137 J.C. Miller Hall, Baton Rouge, LA 70803-2120 USA; <sup>3</sup>Institute of Plant Sciences, The Volcani Center, Agricultural Research Organization, P.O. Box 6, Bet Dagan, 50250, Israel. (avillordon@agcenter.lsu.edu).

**10:15 Beauregard' and 'Evangeline' adventitious root developmental response to 1-MCP treatment.** Arthur Villordon<sup>1\*</sup>, Christopher Clark<sup>2</sup>, Don LaBonte<sup>3</sup>, and Nurit Firon<sup>4</sup>, <sup>1</sup>LSU AgCenter Sweet Potato Research Station, Chase, LA 71324 USA; <sup>2</sup>LSU AgCenter Department of Plant Pathology and Crop Physiology, 302 Life Sciences Bldg., Baton Rouge, LA 70803-2120 USA; <sup>3</sup>LSU AgCenter School of Plant, Environmental, and Soil Sciences, 137 J.C. Miller Hall, Baton Rouge, LA 70803-2120 USA; <sup>4</sup>Institute of Plant Sciences, The Volcani Center, Agricultural Research Organization, P.O. Box 6, Bet Dagan, 50250, Israel. (avillordon@agcenter.lsu.edu).

**10:30 Break**

**11:00 Fertilizer Applications to Mississippi Sweetpotato.** Mark W. Shankle\*, Trevor F. Garrett, Ramon A. Arancibia, and Jeff L. Main, Pontotoc Ridge-Flatwoods Branch Experiment Station, North Mississippi Research and Extension Center, Mississippi State University, Pontotoc, MS 38863. (shankle@ra.msstate.edu).

**11:15 On-farm Validation of a Prototype Production Model for Storage Root Yield in Louisiana: Observation from Producer Fields.** T. P. Smith\*, A. Villordon, T. Arnold, Sweet Potato Research Station, LSU Agricultural Center, Chase, LA 71324. (TSmith@agcenter.lsu.edu).

**11:30 Winter Cover Crops Effect on Soil Characteristics and Sweetpotato Production in North Mississippi.** Jeff L. Main\* and Ramon A. Arancibia, Pontotoc Ridge-Flatwoods Branch Experiment Station, North Mississippi Research and Extension Center, Mississippi State University, Pontotoc, MS 38863. (jmain@ra.msstate.edu).

**11:45 Use of Stale Beds in North Mississippi Sweetpotato Production.** Jeff L. Main\* and Ramon A. Arancibia, Pontotoc Ridge-Flatwoods Branch Experiment Station, North Mississippi Research and Extension Center, Mississippi State University, Pontotoc, MS 38863. (jmain@ra.msstate.edu).

#### **NSCG Student Contest**

Presiding: Ramon A. Arancibia (Mississippi State University); raa66@msstate.edu.

**1:00 Infection of sweetpotato by fungal end rot pathogens prior to harvest.** W. L. da Silva, and C. A. Clark, Department of Plant Pathology and Crop Physiology, Louisiana State University Agricultural Center, Baton Rouge, LA 70803. (washingtonufv@gmail.com).

**1:15 Evaluation of Cover Crops and Tillage Systems as IPM Components for Sustainable Sweetpotato Production Systems.** Arun Babu<sup>1\*</sup>, Fred R. Musser<sup>1</sup>, Jack T. Reed<sup>1</sup>, Ramon A. Arancibia<sup>2</sup> and Jeff Main<sup>2</sup>, <sup>1</sup>Department of Biochemistry, Mol. Biol., Entomology & Plant Pathology, Mississippi State University, Starkville, MS 39759; <sup>2</sup>Pontotoc Ridge-Flatwoods Branch Experiment Station, North Mississippi Research and Extension Center, Mississippi State University, 8320 Hwy 15 South, Pontotoc, MS 38863. (christyhorti@gmail.com).

**1:30 A systems approach to managing Palmer amaranth in sweetpotatoes.** S. L. Meyers\*, K. M. Jennings, D. W. Monks, North Carolina State University, Department of Horticultural Science, Box 7609, 2721 Founders Drive,

Raleigh, NC 27695-7609.  
(slmeyers@ncsu.edu).

**1:45 Transplant Holding Time and Environment Affects Yield and Stand of Sweetpotato.**

William (Brad) B. Thompson\*, David W. Monks, Katharine M. Jennings and Jonathan R. Schultheis, North Carolina State University, Department of Horticultural Science, Box 7609, 2721 Founders Drive, Raleigh, NC 27695-7609.  
(brad\_thompson@ncsu.edu).

**2:00 Sweetpotato growth and developmental responses to soil moisture deficits during the early-season.**

Gajanayake Karande<sup>1</sup>, K. Raja Reddy<sup>1</sup>, Mark Shankle<sup>2</sup> and Ramon Arancibia<sup>2</sup>, <sup>1</sup>Department of Plant and Soil Sciences, Mississippi State University, Mississippi State, MS 39762, <sup>2</sup>Pontotoc Ridge-Flatwoods Branch, Mississippi State University, 8320 Hwy 15 South, Pontotoc, MS 38863. (kcg79@msstate.edu).

**2:15 Nitrogen fertilizer rate influences greenhouse sweetpotato plant production.**

Chen Jiang\*, Zvezdana Pesic-VanEsbroeck and Jonathan R. Schultheis, North Carolina State University, Department of Horticultural Science, Box 7609, 2721 Founders Drive, Raleigh, NC 27695-7609. (cjiang5@ncsu.edu).

**2:30 Determining the Resistance to Fracture and the Breaking Point of Sweetpotato Periderm by Three Mechanical Testers.**

Nestor Bonilla<sup>1\*</sup>, Ramon A. Arancibia<sup>2</sup>, Frank Matta<sup>1</sup>, Juan Silva<sup>3</sup>, Don LaBonte<sup>4</sup>, Mark Shankle<sup>2</sup>, and Raja Reddy<sup>1</sup>, <sup>1</sup>Plant and Soil Sciences Dept. Mississippi State University, 117 Dorman Hall, Mississippi State, MS 39762; <sup>2</sup>Pontotoc Ridge-Flatwoods Branch Experiment Station, North Mississippi Research and Extension Center, Mississippi State University, Pontotoc, MS 38863; <sup>3</sup>Food Sciences, Nutrition and Health Promotion, Mississippi State University, Miss. State, MS; <sup>4</sup>School of Plant, Environmental, and Soil Sciences, Louisiana State University Agricultural Center, Baton Rouge, LA 70803. (njb13@msstate.edu).

**2:45 Influence of Fermentation Times on Ethanol (EtOH) Production from Eleven Sweetpotato Cultivars.**

Joshua Madison\*, Karine Nyiawung, Desmond G. Mortley, Conrad K. Bonsi., and Barrett T. Vaughan,

G.W. Carver Agricultural Experiment Station, Tuskegee University, Tuskegee AL 36088.

**3:00 Break**

**3:30 Prospects for Evaluating Shape and Size Characteristics of Sweetpotatoes (*Ipomoea batatas* L.) Using Digital Image Analysis.**

Robert L. Vick, Jr. and Michael D. Boyette, Department of Biological and Agricultural Engineering, North Carolina State University, Raleigh, NC 27695-7625. (rlvick@ncsu.edu).

**3:45 Advances in Sweetpotato Storage Conditions in North Carolina.**

Jose Garzon\* and Michael Boyette. Department of Biological and Agricultural Engineering, North Carolina State University, Campus Box 7625, Raleigh, NC 27695. (jggarzon@ncsu.edu).

**4:00 Identification of novel genes associated with the onset of storage root formation and in response to drought stress.**

Julio Solis<sup>1</sup>, Arthur Villordon<sup>2</sup>, Nurit Firon<sup>3</sup>, Niranjan Baisakh<sup>1</sup>, Don Labonte<sup>1</sup>, <sup>1</sup>School of Plant, Environmental, and Soil Sciences, LSU AgCenter, Louisiana State University; <sup>2</sup>Professor, Sweet Potato Research Station (SPRS), LSUAC; <sup>3</sup>Inst. of Plant Sciences, The Volcani Center, ARO, P.O. Box 6, Bet Dagan, 50250, Israel. (jsolis2@tigers.lsu.edu).

**4:15 Combining ability of sweetpotatoes for traits of industrial importance.**

Steven Todd<sup>1</sup>, Van-Den Truong<sup>2</sup>, Ken Pecota<sup>1</sup>, G. Craig Yencho<sup>1</sup>, Department of Horticultural Science, North Carolina State University, <sup>1</sup>2721 Founders Drive, Raleigh, NC, 27695; <sup>2</sup>USDA-ARS Food Science Research Unit, 322 Schaub Hall, NCSU Box 7624, Raleigh, NC, 27695. (smtodd@ncsu.edu).

**4:30 Interspecific hybridization of Sweetpotato (*Ipomoea batatas* L.) with Morning Glory Species (*Ipomoea spp* L.).**

Benjamin K. Winslow<sup>1\*</sup>, Shyamalrau P. Tallury<sup>2</sup>, and G. Craig Yencho<sup>1</sup>, <sup>1</sup>North Carolina State University, 1214-A Kilgore Hall, Raleigh, NC 27695-7609; <sup>2</sup>North Carolina State University, 216 Method Unit 3, Raleigh, NC, 27695-7629. (ben\_winslow@ncsu.edu).

**4:45 Plant Spacing Impacts on Herbicide Programs.**

Donnie K. Miller<sup>1\*</sup>, T. P. Smith<sup>2</sup>, and M. Mathews<sup>1</sup>. <sup>1</sup>Northeast Research Station, LSU Agricultural Center, St. Joseph, LA, <sup>2</sup>Sweet Potato Research Station, LSU

Agricultural Center Chase, LA 71324.  
(DMiller@agcenter.lsu.edu).

### 5:00 Sweetpotato Poster session

Room: MFCC Medical Forum A

1. **Atmospheric conditions effect the growth and development of *Rhizopus stolonifera* and *Penicillium*.** R. R. Sweany<sup>1</sup>, D.H. Picha<sup>2</sup>, and C.A. Clark<sup>1</sup>, Department of Plant Pathology and Crop Physiology<sup>1</sup>; School of Plant, Environmental and Soil Sciences<sup>2</sup>, Louisiana State University, Baton Rouge, LA 70803. (dpicha@agctr.lsu.edu).
2. **Identification of genes involved during healing in response to skinning injury in sweetpotato [*Ipomoea batatas* (L.) Lam.].** Jollanda Effendy, Don La Bonte, Niranjana Baisakh, School of Plant, Environmental, and Soil Sciences, Louisiana State University Agricultural Center, Baton Rouge, LA 70803. (DLabonte@agcenter.lsu.edu).
3. **Evaluation of Various Insecticide Regimes in Sweetpotato Production for Sugarcane Beetle Control in the Mid-South.** Larry Adams<sup>1</sup>, Randall Luttrell<sup>1</sup> and Tara Smith<sup>2</sup>, <sup>1</sup>USDA, ARS, SIMRU, Stoneville, MS; <sup>2</sup>LSU AgCenter, Chase, LA 71324. (Larry.Adams@ars.usda.gov).
4. **2011 Product Evaluation and Varietal Differences for Reniform Nematode Suppression in Mississippi Delta Sweetpotato Production.** Larry Adams and Randy Luttrell, USDA, ARS, SIMRU Stoneville, MS. (Larry.Adams@ars.usda.gov).

**Sunday, February 5, 2012**

### Sweetpotato Insect, Disease, and Weed Management

Presiding: Mark Shankle (Mississippi State University); (shankle@ra.msstate.edu).

- 8:00 **Weed Management Issues in Sweetpotato Production.** Mark W. Shankle\*, Trevor F. Garrett, Ramon A. Arancibia, and Issah A. Abukari, Pontotoc Ridge-Flatwoods Branch Experiment Station, North Mississippi Research and Extension Center, Mississippi State University, Pontotoc, MS 38863. (shankle@ra.msstate.edu).
- 8:15 **Evaluation of Selected Insecticides Regimes for Management of Sugarcane Beetle in**

**Sweetpotato.** T. P. Smith\*<sup>1</sup>, L. Adams<sup>2</sup>, R. Luttrell<sup>2</sup>, T. Arnold<sup>1</sup>, <sup>1</sup>Sweet Potato Research Station, LSU Agricultural Center, Chase, LA; <sup>2</sup>Southern Insect Management Research Unit, USDA, Stoneville, MS. (TSmith@agcenter.lsu.edu).

- 8:30 **Use of insecticides to control the spread of sweetpotato leaf curl virus in sweetpotato fields.** D. Michael Jackson\*, Kai-Shu Ling, and Alvin M. Simmons. USDA-ARS, U.S. Vegetable Laboratory, 2700 Savannah Highway, Charleston, SC 29414. (Mike.Jackson@ars.usda.gov).
- 8:45 **Potyvirus incidence in Mississippi sweetpotato fields and effect on storage root initiation.** Ramon A. Arancibia\*<sup>1</sup>, Chris Clark<sup>2</sup>, Lori Grelen<sup>1</sup>, Everlyne Wosula<sup>2</sup>, Xiang Wang<sup>1</sup>, and Jeff Main<sup>1</sup>, <sup>1</sup>Pontotoc Ridge-Flatwoods Branch Experiment Station, North Mississippi Research and Extension Center, Mississippi State University, Pontotoc, MS 38863; <sup>2</sup>Department of Plant Pathology and Crop Physiology, Louisiana State University, Baton Rouge, LA 70803. (raa66@msstate.edu).
- 9:00 **Diversity, Densities, and Distribution of Microbial Communities in Sweetpotato End/Tip Rot Diseases.** C.E. Stokes\*<sup>1</sup>, S.W. Woolfolk<sup>1</sup>, R.A. Arancibia<sup>2</sup>, and R.E. Baird<sup>1</sup>, <sup>1</sup>Department of Biochemistry, Molecular Biology, Entomology and Plant Pathology, Mississippi State University, MS 39762; <sup>2</sup>Pontotoc Ridge-Flatwoods Branch Experiment Station, North Mississippi Research and Extension Center, Mississippi State University, Pontotoc, MS 38863. (bstokes@plantpath.msstate.edu).
- 9:15 **Evaluation of postharvest hot water treatments and bio-control agents for suppression of *Rhizopus* soft rot on sweetpotatoes.** R. R. Sweany<sup>1</sup>, D.H. Picha<sup>2</sup>, and C.A. Clark<sup>1</sup>, <sup>1</sup>Department of Plant Pathology and Crop Physiology; <sup>2</sup>School of Plant, Environmental and Soil Sciences, Louisiana State University, Baton Rouge, LA 70803. (dpicha@agctr.lsu.edu).

### Sweetpotato Post Harvest Physiology, Food Science, and Marketing

Presiding: Arnold Caylor (Auburn University) (cayloaw@auburn.edu).

**9:30 Effect of curing temperature and duration on sweetpotato sugar content.** D.H. Picha\* and M. S. Bowen, School of Plant, Environmental and Soil Sciences, Louisiana State University, Baton Rouge, LA 70803. (dpicha@agctr.lsu.edu).

**9:45 Atmospheric gas composition influences sweetpotato carbohydrate content.** D.H. Picha\* and M. S. Bowen, School of Plant, Environmental and Soil Sciences, Louisiana State University, Baton Rouge, LA 70803. (dpicha@agctr.lsu.edu).

**10:00 Baked Sweetpotato (*Ipomoea batatas* L. Lam) Quality is Affected by Preharvest Ethylene and Postharvest Curing.** Ershad Sheibani<sup>1</sup>, Ramon Arancibia<sup>2</sup>, Taejo Kim<sup>1</sup>, Jeff Main<sup>2</sup>, David H. Picha<sup>3</sup>, Frank B. Matta<sup>4</sup>, and Juan L. Silva<sup>1\*</sup>, <sup>1</sup>Department of Food Science, Nutrition and Health Promotion, Mississippi State University, Miss. State, MS 39762; <sup>2</sup>NMREC-Pontotoc Ridge-Flatwoods Branch Experiment Station, Mississippi State University, Pontotoc, MS 38863; <sup>3</sup>School of Plant, Environmental and Soil Sciences, Louisiana State University, Baton Rouge, LA 70803; <sup>4</sup>Dept. of Plant and Soil Sciences, Mississippi State University, Miss. State, MS 39762. (jls46@msstate.edu).

**10:15 Drying Sweetpotatoes for Value Added Products.** Michael D. Boyette, Ph.D., P.E, Department of Biological and Agricultural Engineering, North Carolina State University. (mike\_boyette@ncsu.edu).

**10: 30 Break**

### Watermelon Research Group

**Presiding:** Jonathan Schultheis, Chair  
(jonr@ncsu.edu)

**Sunday:** 8:00 am – 4:00 pm

**Room:** SBH Birmingham Ballroom XI

**Watermelon Fruit Age and Development of Phytophthora fruit rot on resistant and susceptible lines.** Chandrasekar S. Kousik\* and Jennifer L. Ikerd, U.S. Vegetable Laboratory, USDA, ARS, Charleston, SC 29414. (Shaker.Kousik@ar.usda.gov).

**The Effect of Growth Regulator Applications and Pollen Availability on Fruit Set and Hollow Heart in Triploid Watermelons.** Gordon C. Johnson\* and

Emmalea G. Ernest, University of Delaware, Carvel REC, 16483 County Seat Highway, Georgetown, DE 19947. (gcjohn@udel.edu).

**Delaware Triploid Watermelon Cultivar Evaluations and Pollenizer Cultivar Evaluations for Triploid Watermelon Production.** Gordon C. Johnson and Emmalea G. Ernest\*, University of Delaware, Carvel REC, 16483 County Seat Highway, Georgetown, DE 19947. (gcjohn@udel.edu).

**Effects of Grafted Transplants on Postharvest Fruit Quality of Three Different Seedless Watermelon Cultivars.** Richard L. Hassell, Clemson University CREC, 2700 Savannah Highway, Charleston, SC. 29414. (rhassell@clemson.edu).

**Watermelon Cultivar Yield and Quality Results in North Carolina 2010 Trial.** Jonathan R. Schultheis\* and William (Brad) B. Thompson. North Carolina State University, Kilgore Hall, 2721 Founders Drive, Box 7609, Raleigh, NC 27695-7609. (jonathan\_schultheis@ncsu.edu).

**Genetic Diversity among *Citrullus lanatus* var. *lanatus* and *C. lanatus* var. *citroides* PIs Useful for Enhancing Disease or Pest Resistance Among Watermelon Cultivars.** Amnon Levi\*, Judy A. Thies, W. Pat Wechter, Chandrasekar S. Kousik, Howard Harrison, and Alvin Simmons. U.S. Vegetable Laboratory, USDA, ARS, Charleston, SC 29414-5334. (amnon.levi@ars.usda.gov).

**Resistance of wild watermelon (*Citrullus lanatus* var. *citroides*) rootstocks to southern root-knot nematode.** Judy A. Thies\*<sup>1</sup>, Jennifer J. Ariss<sup>1</sup>, Richard L. Hassell<sup>2</sup>, and Amnon Levi<sup>1</sup>. <sup>1</sup>U.S. Vegetable Laboratory, USDA, ARS, Charleston, SC 29414; <sup>2</sup>Clemson Coastal Research & Education Center, Clemson University, Charleston, SC 29414. (Judy.Thies@ars.usda.gov).

**Evaluation of triploid watermelon cultivars for resistance to Fusarium wilt.** Kathryn L. Everts, University of Maryland, Department of Plant Science and Landscape Architecture, College Park, MD 20742. (keverts@umd.edu).

**Effect of SqVYV Resistant Pollinizers on Development and Spread of Watermelon Vine Decline on Seedless Watermelon.** C.S. Kousik<sup>1\*</sup>, Scott Adkins<sup>2</sup>, Craig Webster<sup>2</sup>, William Turechek<sup>2</sup> and Pamela D. Roberts<sup>3</sup>, <sup>1</sup>U.S. Vegetable Laboratory, USDA, ARS, Charleston, SC 29414, <sup>2</sup>U.S. Horticultural Research Laboratory, USDA-ARS, Ft. Pierce, FL 34945 and <sup>3</sup>SWFREC, University of Florida, Immokalee, FL 34142. (shaker.kousik@ars.usda.gov).

**Impact of pre-plant ABA applications on growth and yield of watermelon transplants.** Daniel I. Leskovar\* and Shinsuke Agehara, Texas AgriLife Research, Texas A&M System, 1619 Garner Field Rd., Uvalde TX 78801. (d-leskovar@tamu.edu).

### **S. Blueberry/Small Fruit Workers**

**Presiding:** Elina Coneva, Chair  
(edc0001@auburn.edu)  
**Saturday:** 8:00 am – 5:00 pm  
**Room:** SBH Birmingham Ballroom III

**Extending the Season for Strawberry Production in Arkansas.** M. Elena Garcia\*, D. Dickey, and C. Vincent, Department of Horticulture, University of Arkansas, Fayetteville, AR 72701. (megarcia@uark.edu).

**Building an “All About Blueberries” Web Portal to Share Knowledge and Sustain Blueberry Production.,** Elina D. Coneva\*<sup>1</sup>, Natalie A. Hummel<sup>2</sup>, A. Denise Attaway<sup>2</sup>, John Braswell<sup>3</sup>, William O. Cline<sup>4</sup>, Donna Marshall<sup>5</sup>, Don M. Ferrin<sup>6</sup>, Krisanna L. Machtmes<sup>7</sup>, and Heli J. Roy, <sup>1</sup>101 Funchess Hall, Department of Horticulture, Auburn University, Auburn, AL 36849; <sup>2</sup>LSU AgCenter, Department of Entomology, 404 Life Sciences Bldg., Baton Rouge, LA 70803; <sup>3</sup>Mississippi State University–Coastal Research and Extension Center, PO Box 193, Poplarville, MS 39470; <sup>4</sup>North Carolina State University, Horticultural Crops Research Station, 3800 Castle Hayne Rd., Castle Hayne, NC 28429; <sup>5</sup>USDA-ARS, Southern Horticultural Laboratory, PO Box 287, Poplarville, MS 39470; <sup>6</sup>LSU AgCenter Department of Plant Pathology and Crop Physiology, 432 Life Sciences Bldg, Baton Rouge, LA 70803; <sup>7</sup>LSU AgCenter, School of Human Resources Education and Workforce Development, 142 Old Forestry Bldg., Baton Rouge, LA 70803; <sup>8</sup>LSU AgCenter, Nutrition and Health, 275 Knapp Hall, Baton Rouge, LA 70803. (Edc0001@auburn.edu).

### **National Cowpea Improvement Assoc.**

**Presiding:** J. Trachta, Chair  
(john@ctsmithco.com)  
**Sunday:** 1:00 pm – 4:00 pm  
**Room:** SBH Birmingham Ballroom III

### **Horticulture Administrators**

**Presiding:** Doug Bailey, Chair  
(dabailey@uga.edu)  
**Saturday:** 1:00 pm – 4:00 pm  
**Room:** SBH Jefferson Boardroom 2

### **Vigna Crop Germplasm Committee**

**Presiding:** Jeff Ehlers  
(jeff.ehlers@ucr.edu)  
**Sunday:** 9:00 am – 12:00 pm  
**Room:** SBH Birmingham Ballroom III

### **Pecan Research and Extension Forum**

**Presiding:** Monte Nesbitt, Chair  
(mlnesbitt@ag.tamu.edu)  
**Saturday:** 8:00 am – 5:00 pm  
**Room:** SBH Birmingham Ballroom V/IX



## ASHS Certified Horticulturist Examination

### American Society for Horticultural Science

1018 Duke Street  
Alexandria, VA 22314

phone: 703.836.4606 fax: 703.836.2024

E-mail: [ashsch@ashs.org](mailto:ashsch@ashs.org)

#### Examination

Saturday, February 4, 8:00am–12:00 p.m., Sheraton Birmingham Hotel, Jefferson Boardroom 2

#### Application and Deadlines

Go to the ASHS website ([ashs.org](http://ashs.org)) to download the ASHS Certified Horticulturist Candidate Handbook and the Application. Applications and proper payment must be received in the ASHS office no later than 14 (fourteen) working days before a scheduled exam. Deadline for this Exam is January 21. No exceptions.

#### Fees for the Examination

ASHS Members—\$160.00; Non-members—\$235.00

#### For additional information:

- Download from [ashs.org](http://ashs.org): [CH Booklet](#); [CH Study Outline](#); [Application to sit for the ASHS CH Examination](#)

#### Format of the Examination

- The certification examination consists of 200 multiple-choice questions.
- Each question has four choices listed, only one of which is correct. The answer to each question can be derived independently of the answer to any other question.
- You will have 4 hours to complete the examination. It is always advisable to first answer the questions that are easy for you, skipping over those questions to which you will need to return to give more thought. Working in such a manner, you should feel no time pressure because 4 hours will be more than enough time to complete the examination.
- You must achieve an overall score of at least 71%. If you do NOT achieve a passing score, you must retake the exam. You will be allowed to retake the exam one time for \$100 within one year of the original test date. After one year from the original test date, you must again pay the full exam fee of \$160 for members of ASHS or \$235 for nonmembers.

#### Content of the Certification Examination

The certification examination is designed to test your understanding of the following topics:

- Landscape Design and Maintenance
- Production of Fruits, Vegetables, Turf and Ornamental Plants
- Shipping and Handling of Final Product
- Propagation
- Monitoring and Testing
- Diagnosing and Managing Plant Problems
- Business Practices

#### Examination Eligibility Requirements

The ASHS Certified Horticulturist Board requires candidates to have a minimum of:

- three (3) years of paid fulltime experience in Horticulture, or
- a two-year degree in Horticulture and two (2) years of paid practical experience, or
- a four-year degree in Horticulture or a related field and one (1) year of paid practical experience.

By submitting your application, you authorize ASHS certification staff to contact the practical experience reference named on your application to substantiate your eligibility.

*The ASHS Certified Horticulturist Program does not discriminate in determining eligibility on the basis of race, color, religion, gender, national origin, age, disability, or any other characteristic protected by law.*

## Instructions for Submission of Abstracts for Publication in *HortScience*

### To publish your abstract in *HortScience*:

- 1) One of the authors must be registered for the conference.
- 2) The title of the abstract must appear in the published conference program.
- 3) The abstract must be submitted as a document file in the proper format.
- 4) The abstract must be submitted to the Chair of the session by the deadline.

### Submission of Abstract

**File Format:** Each abstracts must be submitted as a separate Word (.doc) file. If you use another word processing language, submit abstract in rich text format (.rtf).

**Deadline:**

- 1) At meeting: Give disk with file to the Chair of the session.
- 2) Email abstracts as an attached file to the Chair of the session before the meeting or within a few days after the meeting. See the Section Program for the Chair's email address.

### Abstract Format

**Length:** Limit the abstract body to about 2000 characters.

**Font:** 12 point, Times New Roman or similar

**Format:** Format abstract as below. Asterisk denotes presenting author.

### Example Format

#### **Molecular Marker-Derived Genetic Similarity Analysis of a Segregating Blackberry Population**

Eric T. Stafne\*<sup>1</sup>, John R. Clark<sup>1</sup>, and Kim S. Lewers<sup>2</sup>

<sup>1</sup>316 Plant Sciences, Department of Horticulture, University of Arkansas, Fayetteville, AR 72701, <sup>2</sup>USDA-ARS Fruit Lab, 10300 Baltimore Ave., BARC-West Bldg. 010A, Beltsville, MD 20705

A tetraploid blackberry population that segregates for two important morphological traits, thornlessness and primocane fruiting, was tested with molecular marker analysis. Both randomly amplified polymorphic DNA (RAPD) and simple sequence repeat (SSR) markers were used to screen a population of 98 genotypes within the population plus the two parents, 'Arapaho' and 'Prime-Jim'<sup>®</sup> (APF-12). RAPD analysis averaged 3.4 markers per primer, whereas SSR analysis yielded 3.0 markers per primer pair. Similarity coefficient derived from the Dice index averaged over all individuals was 63% for RAPD markers, 73% for SSR markers, and 66% for RAPD and SSR markers together. The average similarity coefficients ranged from a high of 72% to a low of 38% for RAPD markers, 80% to 57% for SSR markers, and 73% to 55% for both. Comparison of the parents indicated a similarity of 67% for RAPD markers, 62% for SSR markers, and 67% for both. This is similar to a previous study that reported the similarity coefficient at 66%. Although inbreeding exists within the population, the level of heterozygosity is high. Also, evidence of tetrasomic inheritance was uncovered within the molecular marker analysis. This population will be used to identify potential markers linked to both morphological traits of interest. Further genetic linkage analysis and mapping is needed to identify any putative markers.

## 2012 Program at a Glance

### Friday February 3

Bldg	Room	8:00				9:00					10:00					11:00					12:00					1:00					2:00					3:00					4:00					5:00				
MFCC	Medical Forum A	Sweet Potato SCRI																																																

### Saturday February 4

Bldg	Room	8:00				9:00					10:00					11:00					12:00					1:00					2:00					3:00					4:00					5:00				
SBH	Sheraton Hotel Lobby	7:00 open Registration																																																
SBH	Birmingham Ballroom V/IX	Pecan Research & Extension Forum																																																
SBH	Birmingham Ballroom III	Southern Blueberry/Small Fruit Workers																																																
MFCC	Medical Forum A	National Sweet Potato Collaborators																																																
SBH	Jefferson Boardroom 2	Certified Horticulturist																Horticulture Administrators																Executive Com.																
SBH	Birmingham Ballroom IV	ACB Club Share								ACB Group Lunch								Depart for Activities or Tour								ACB Reception																								

### Sunday February 5

Bldg	Room	8:00				9:00					10:00					11:00					12:00					1:00					2:00					3:00					4:00					5:00				
SBH	Birmingham Ballroom Vestibule	7:00 open Registration																																S U P P E A R R T B Y O W L																
SBH	Birmingham Prefunction	Poster Session Set-Up																Poster Session Viewing, Authors at Posters & Judging																																
MFCC	Medical Forum J/K	Judging Contest Set-Up																J. Benton Storey Horticulture Judging Contest																																
SBH	Birmingham Ballroom XI	Watermelon Research Group																																																
SBH	Birmingham Ballroom III	Vigna Crop Germplasm Committee																National Cowpea Improvement Association																																
MFCC	Medical Forum A	National Sweet Potato Collaborators																																																
MFCC	Medical Forum D	Extension Section																Education Sect.																																
SBH	Birmingham Ballroom V/IX	Edmond UG Paper Comp.								Childers M.S. Paper Competition																Barham Ph.D. Paper Comp.																								
MFCC	Auditorium Theater	SAAS General Session																																																

### Monday February 6

Bldg	Room	8:00				9:00					10:00					11:00					12:00					1:00					2:00					3:00					4:00					5:00				
SBH	Birmingham Ballroom Vestibule	7:00 open Registration																																																
SBH	Birmingham Prefunction	Poster Session Viewing																Poster Take Down																																
MFCC	Medical Forum Auditorium	ACB Business Meeting								Business Meeting/Awards Prog.																																								
BJCC	East Meeting Room F	Vegetable Crops Section																Vegetable Crops Section																																
BJCC	East Meeting Room G	Floriculture, Ornamentals & Turf Section																Floriculture, Ornamentals & Turf Section																																
BJCC	East Meeting Room I	Fruit Crops Section																Fruit Crops Section																																
BJCC	East Meeting Room H	PostHarvest & Biotechnology Section																																																

**Building Complex**

SBH - Sheraton Birmingham Hotel  
 BJCC - Birmingham-Jefferson Conference Center  
 MFCC - Medical Forum Conference Cent



# Meeting Room Locations

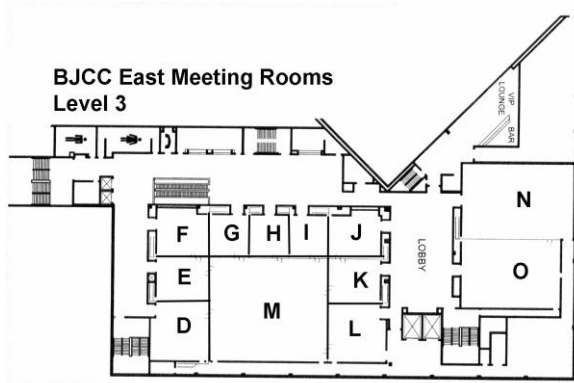

**BJCC**  
Birmingham-Jefferson East Meeting Rooms.

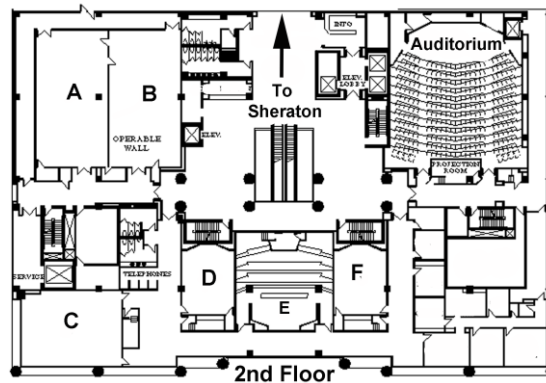

**MFCC**  
Medical Forum Conference Center

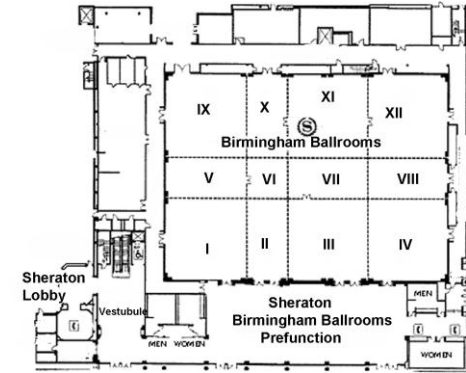

**SBH**  
Sheraton Birmingham Hotel



Meeting Held in:  
 BJCC East Meeting Rooms  
 MFCC Medical Fourm  
 SBH Sheraton Birmingham

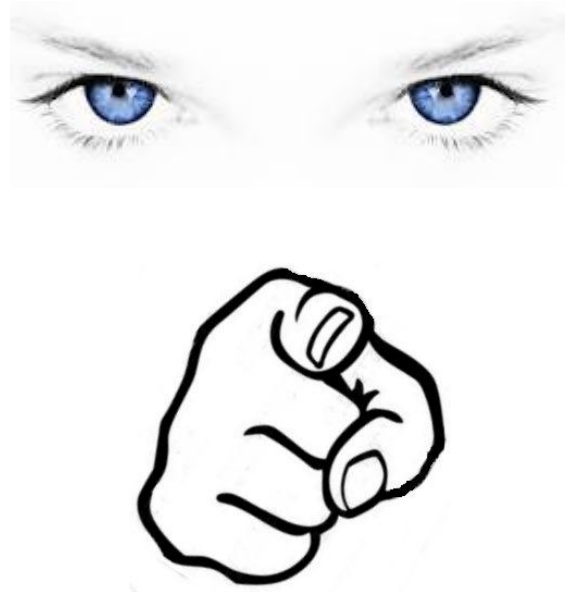

**ASHS**  **miami**  
**31 July - 3 August 2012**